



PROJECT: Jefferson Relief Interceptor

PROJECT NUMBER: 0208-0111-C

SUBJECT: SEMSD Board Report

MEETING DATE: March 26, 2025

The following provides a status update as of the writing of this report (March 21, 2025) for the Jefferson Relief Interceptor Sewer Project construction.

Design Phase

Schedule Status: Ric-Man Construction Schedule (See attached)
Start: February 10, 2025 Finish: March 1, 2027

Schedule Expended: 44 of 749 calendar days as of March 26, 2025

- Ric-Man Construction Company (RCI) was awarded the Jefferson Relief Tunneling Project in the SEMSD Board meeting November 13, 2024.
- A notice to proceed dated February 10, 2025, notified the contractor to commence work within 10 days of receipt.
 - The scheduled RCI start of construction for February 19th was delayed due to Consumers Energy utility relocation at 9 Mile and Jefferson. This postponed the actual start of construction to March 3, 2025. RCI has issued a claim of "Notice of Intent" for extension of time for the construction delay.
 - AEW sent correspondence putting Consumers on notice that any costs associated with delays in construction of the Jefferson Relief Sewer caused by conflicts with gas main relocation will be passed along directly to Consumers.
- The AEW, NTH & Fishbeck engineering team along with SEMSD and St. Clair Shores representatives held a preconstruction meeting February 23, 2025, at the AEW south offices. All contracting and utility representatives were invited and the meeting minutes distributed.
- Construction commenced on March 3rd with mobilization of equipment and the installation of traffic control for Phase 1 from 9 Mile Road to Stephens Street.





- With Traffic control in place AEW survey provided tunnel center line, lateral sewer staking and identified geotechnical monitoring point locations. RCI subcontractor Schmidt Drilling Co. followed with installation of geotechnical monitoring points for recording potential ground movement during construction.



- AEW approved the RCI submitted substitution request for the change in location of the Phase 1 launching and receiving shafts, siphon pipe material and additional open cut at the 9 Mile Road connection. The AEW designed revised connection at 9 Mile Road required updating the EGLE Part 41 permit, which was approved March 12, 2025. The substitution is at no additional cost to the contract and could improve the schedule.

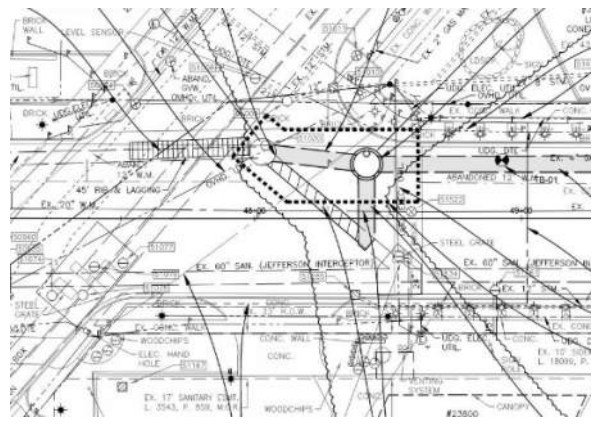
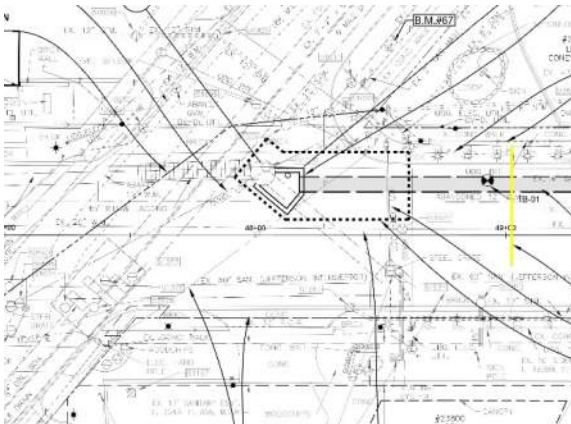



- RCI provided a preliminary shaft relocation plan for the remainder of the construction phases.
 - If adopted the temporary ingress agreements to facilitate access for Rosemary and Maple Streets through 100 Maple Park Blvd, Maple Park Office Plaza LLC. property would no longer be necessary.
 - City of St Clair Shore representatives are still preparing an ingress egress agreement to present to the Shorepointe owner, Charles Dun. Mr. Dun verbally agreed to allow a B Street approach to serve his and the Macomb County Public Works Office Martin RTB facility in our initial meeting September of 2024. Mr. Dun also requested the rededication of Bon Brea Street back to the City of St Clair Shores.
- RCI started excavation by installing the tail tunnel piping and tunnel launching shaft at 9 Mile Road.
 - Unfortunately, the street lighting conduit was shallow, unmarked and cast into the road pavement resulting in electrical conduit damage during roadway pavement removal. RCI will coordinate the repair of the lighting electrical upon completing the excavation of the shaft.
 - While preparing to install the temporary earth retention system for the open cut excavation the trench box shifted and cut into the 4" gas main. AEW personnel called 911 and all project representatives were notified. Consumers Energy forces mobilized to the site and made the repair.
 - The CAT 395 excavator counterweight impacted one of the flagpoles causing it to lean. The pole was straightened and supported with straps. The flagpole was not damaged as the pole base moved with it due to undermining from the excavation. Per AEW request the St. Clair Shores DPW removed the flags from the poles to eliminate the wind load. The undermined flagpole bases will require removal and replacement.
 - It should be noted that the open cut excavation and shaft relocation is part of the RCI substitution and subsequently any impacts are the contractor's responsibility to repair or replace at no additional cost to the contract.





- Ric-Man Construction established a storefront office located at 23409 Jefferson, Suite 110 St. Clair Shores for engineering and contracting staff.
- Safety concerns have been expressed by engineering and ownership representatives to Ric-Man for the traffic control signage blowing over during to weather events. Ric-Man has agreed to address this issue with their subcontractor "Give Em a Brake" to increase the sign base weight with additional sandbags or anchor with driven posts for signs outside of the pavement limits.
- Ric-Man started the first siphon installation for the side street lateral at Ridgeway Street. AEW and contractor field staff will be monitoring the flow elevation on both sides of the siphon once constructed.
- Based on the updated schedule RCI is to start tunneling on March 31st.



Project Manager: Matthew Richter

Schedule Preparation Date: 03/19/25

Project: SEMSD Jefferson Relief Sewer		Manpower Schedule (Indicate any change in manpower based on the week's starting crew size in the space provide)																				
		Crew Size	3/24	3/25	3/26	3/27	3/28	3/29	Crew Size	3/31	4/1	4/2	4/3	4/4	4/5	Crew Size	4/7	4/8	4/9	4/10	4/11	4/12
			M	T	W	Th	F	S		M	T	W	Th	F	S		M	T	W	Th	F	S
Task to Be Performed		Week # 1						Week # 2						Week # 3								
Tunnel Crew (Jeff McMillan)																						
Open Cut Tail Tunnel Shaft #1																						
Tunnel Shaft #1 Excavation		X																				
Tunnel Machine - Mobilized		X	X																			
Tunnel Machine - Field Prep		X	X	X	X	X																
Tunnel Machine - Launch									X													
Tunnel Machine - Begin Mining 60-Inch Pipe									X	X	X	X	X									
60-Inch RCP Installation																X	X	X	X	X		
Sanitary Pipe Crew (Wade Winterbottom)																						
Sanitary Sewer Raise @ Harper Lake		X	X	X	X	X																
Sanitary Sewer Siphon @ Laukel									X	X	X	X	X									
Sanitary Sewer Raise @ Stephens																X	X	X	X	X		